

ART FOR ALL: CONNECTING CAMPUS AND COMMUNITY

HOUSATONIC MUSEUM OF ART

OCTOBER 10, 2024

JENNIFER REYNOLDS-KAYE, HOUSATONIC MUSEUM OF ART (CT)

The Housatonic Museum of Art (HMA) holds one of the largest art collections of any community college in the United States with almost 7,000 artworks. Unlike most campus museums, the HMA displays selections of its collection throughout CT State Housatonic.

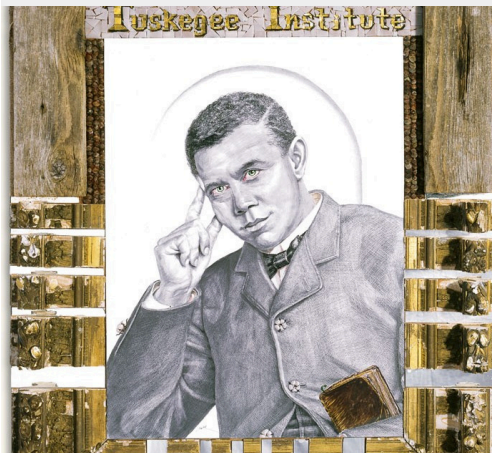

KELLY ELMORE, KATHRYN TUCKER WINDHAM MUSEUM (ALABAMA)

The Kathryn Tucker Windham Museum was established in 2003 to celebrate the works of Alabama native Kathryn Tucker Windham. The museum showcases literary works, art works, and Tucker Windham's expansive photography collection in a collection that celebrates Folk Art of the southeastern United States.

ALESSANDRA MOCTEZUMA, SAN DIEGO MESA COLLEGE ART GALLERY (CA)

The San Diego Mesa College Art Gallery is an educational forum to present the work of contemporary artists in a range of media and dealing with diverse issues. The gallery showcases outstanding artwork created by students in the Art Department. It also serves as a learning laboratory for the Museum Studies students to learn and practice skills relating to curation and exhibit installation.



TERRA
FOUNDATION FOR AMERICAN ART

cthumanities

HOUSATONIC
MUSEUM OF ART



CONNECTICUT

AAMG
Association of Academic Museums & Galleries

CT STATE
COMMUNITY COLLEGE
HOUSATONIC

ART FOR ALL: CONNECTING CAMPUS AND COMMUNITY

HOUSATONIC MUSEUM OF ART

OCTOBER 10, 2024

JOANNE NORTHRUP, NERMAN MUSEUM OF CONTEMPORARY ART (KANSAS)

The Nerman Museum of Contemporary Art is an art museum that is part of Johnson County Community College in Overland Park, Kansas. The 38,000 square foot building was designed by Kyu Sung Woo Architects. The collection includes approximately 2,000 artworks from 1980 to the present.

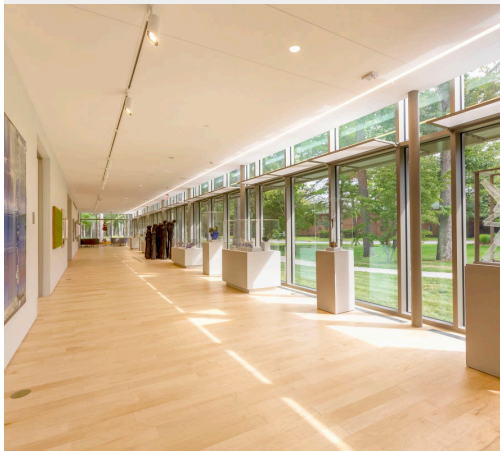

CRAIG HADLEY, DENNOS MUSEUM CENTER (MICHIGAN)

Opened in 1991 and expanded in 2018, the 60,000 square foot Dennis Museum Center is located on the campus of Northwestern Michigan College in Traverse City, MI. The museum curates one of the largest contemporary Inuit art collections in the United States, with over 2,000 prints and sculptures ranging from the late 1950s to present day.

CYNTHIA BRANNVALL, FOOTHILL COLLEGE (CALIFORNIA)

Krause Center for Innovation Gallery is a small gallery adjacent to the maker space that focuses on introducing teachers and students to new technologies including laser cutters, 3D printers, sewing machines, vinyl cutters, soldering irons and much more. Gallery exhibitions are focused on photographic art.



TERRA
FOUNDATION FOR AMERICAN ART

cthumanities

HOUSATONIC
MUSEUM OF ART

CONNECTICUT

AAMG
Association of Academic Museums & Galleries

CT STATE
COMMUNITY COLLEGE
HOUSATONIC

ART FOR ALL: CONNECTING CAMPUS AND COMMUNITY

HOUSATONIC MUSEUM OF ART

OCTOBER 10, 2024

PETER BONFITTO, THE ART GALLERIES (TAG) AT AUSTIN COMMUNITY COLLEGE (TEXAS)

The Art Galleries (TAG) was created in 2020 to support the college's art program and foster new relationships with the growing art communities of Central Texas and beyond. TAG's mission is to create accessibility to art, promote a diversity of artistic perspectives, and to provide educational spaces that cultivate creativity and critical thinking.



NATHALIE SÁNCHEZ, ARTS EDUCATION AND MUSEUM LEADERSHIP (CA)

Nathalie previously worked as a visual arts teacher for arts education non-profit organizations and museum educator with two academic museums: Fowler Museum at UCLA and the Vincent Price Art Museum at East Los Angeles College.

APRIL OSWALD, MUNSON MUSEUM OF ART (NEW YORK)

MUNSON includes the Munson Museum of Art with a renowned permanent collection with strengths in 19th and 20th-century American art, works on paper, and decorative arts. The School of Art includes both an accredited college program in association with Pratt Institute as well as community arts classes for adults, teens, and children.



TERRA
FOUNDATION FOR AMERICAN ART

cthumanities

HOUSATONIC
MUSEUM OF ART



CONNECTICUT

AAMG
Association of Academic Museums & Galleries

CT STATE
COMMUNITY COLLEGE
HOUSATONIC

ART FOR ALL: CONNECTING CAMPUS AND COMMUNITY

HOUSATONIC MUSEUM OF ART

OCTOBER 10, 2024

MARILYN KRALIK, FOUNDATION ART COLLECTION, OCEAN COUNTY COLLEGE (NEW JERSEY)

Still in its infancy, the Ocean County College Foundation Art Collection maintains both indoor and outdoor exhibition spaces that enrich and challenge our students as well as our larger community. The collection includes work by the Seward Johnson Atelier and Francesco Scavullo.



JUSTIN WITTE, THE CLEVE CARNEY MUSEUM OF ART (ILLINOIS)

Opened in 2014 and expanded in 2019, the Cleve Carney Museum of Art (CCMA) is located on the campus of the College of DuPage in Glen Ellyn, Illinois. The museum presents contemporary and modern art through rotating exhibitions, public programming, and its permanent collection of over 800 works, including a significant gift from the late Cleve Carney.

ANDREA SIEGEL, PHD, FOUNDATION ART COLLECTION, HUDSON COMMUNITY COLLEGE, NEW JERSEY

The Hudson County Community College Foundation Art Collection includes about 1,500 works of art permanently installed in thematic groups in the public areas of 9 campus buildings, making the entire campus an educational art museum.



TERRA
FOUNDATION FOR AMERICAN ART

cthumanities

HOUSATONIC
MUSEUM OF ART



CONNECTICUT

AAMG
Association of Academic Museums & Galleries

CT STATE
COMMUNITY COLLEGE
HOUSATONIC